



VL4 REVERSE

The VL4 Reverse is a compact reverse light with a stylish streamline design and small dimensions. Approved to ECE R148 & R10, this practical work light can be installed low on the rear of vehicles, where a conventional work light may get damaged due to impacting into curbs and other obstructions. The VL4 Reverse aids operator vision, increasing safety of those around the vehicle and effectively lighting the area behind to reduce damage caused by impacting previously unseen hazards. Ideal for on road applications such as service vehicles, rescue vehicles, trucks and cars. Bracket mounted.

SUGGESTED APPLICATIONS

The VL4 Reverse is highly adaptable and can be used across numerous applications worldwide, including:



ON-ROAD



TECHNICAL DATA

- Housing Material:** Cast Aluminium
- Mounting Options:** Bracket
- Lens Material:** Polycarbonate
- Connector:** Deutsch (DT04-2P) built in
- Weight:** Bracket 358 g / 0.79 lb
- Light Patterns:** Symmetric



Overheating Protection



Over-voltage Protection



Polarity Protection

TEST STANDARDS



Salt Spray ASTM B117 500 h



Vibration 5-2000 Hz 3 Axis, 10 Grms



Shock Tested 50 G 11 ms



IP69K



EN55025 / CISPR 25
ISO 11452-2 / ISO 16750-2 / ISO 7637-2



ECE rated R148 & R10

Consult website for additional lens & mounting options

TYRI's testing standards can be found at: www.tyrilights.com

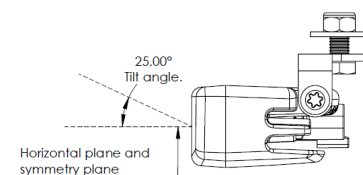
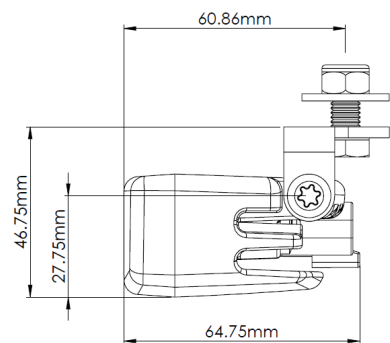
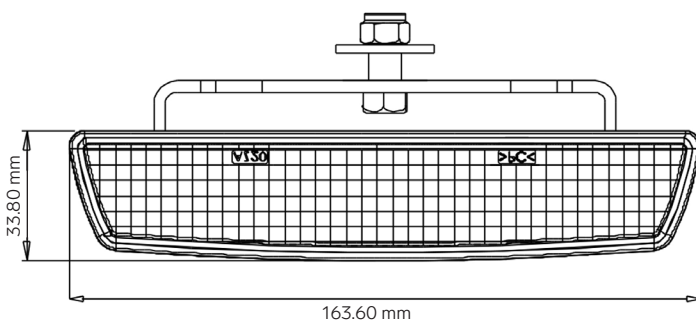



VL4 REVERSE

LIGHT OUTPUT	OPERATING TEMPERATURE	VOLTAGE		AMP DRAW		POWER	COLOUR TEMPERATURE	EMC	ECE
Effective Lumen	°C	Machine	Operating Range	12 V	24 V	Watts	K	EN55025 / CISPR25	ECE Rating
1000 lm	-40 to +85 °C	9-16 V	12 V	1.45 A		18 W	5700	5	R148 / R10