

PRODUCT INFORMATION:

The D8 is now more adaptable than ever, with the introduction of two eLumen options. This high performance light can now be supplied in 1400 and 2500 eLumen making it a flexible and efficient solution. Each model boasts advanced cooling flange design to improve overall heat transfer and are all rated EMC Class 5 / CISPR 25, the highest rating available. The D8 and D8 Swivel are also available with a wide selection of replaceable lenses and bracket possibilities.

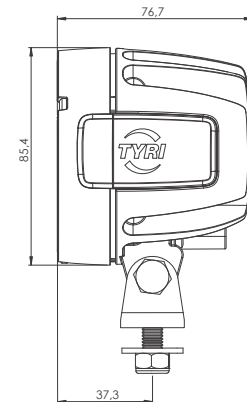
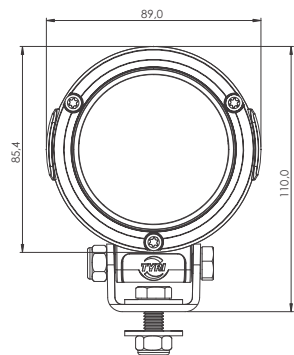

- EMC TESTED
- IP 69K
- VIBRATION TESTED
- SALT SPRAY TESTED

Operating Temp: -40° to 85°C

Light Pattern: Symmetric

Lens Material: Plastic

Housing: Cast Aluminium

Mounting Options: Hanging, Standing

Connector:
Deutsch (DT04-2P) built in

LUMEN OUTPUT		Number of LED'S	VOLTAGE		AMP DRAW		Power (Watts)	Colour Temp	CRI	COMPLIANCE / RATING				
Theoretical	Effective		Machine	Operating Range	12 Volts	24 Volts				EMC EN55025 / CISPR25	IP69K	Vibration 5-2000Hz 3 Axis	Salt Spray ASTMB117	Shock Tested
1800	1400	6	12	9 16	1.8		22	5700	70	5	•	8 Grms	•	•
1800	1400	6	24	18 32		0.9	22	5700	70	5	•	8 Grms	•	•
3000	2500	6	12	9 16	2.4		29	5700	70	5*	•	8 Grms	•	•
3000	2500	6	24	18 32		1.4	33	5700	70	5*	•	8 Grms	•	•