



1313

PRODUCT INFORMATION:

Powerful and adaptable with up to 7000 effective lumen, the 1313 is typically used on large construction and mining vehicles. This work light offers exceptional lumen to watt efficiency ratio and heavy duty housing, ensuring the 1313 delivers in both performance and durability.



EMC TESTED



IP69K



VIBRATION TESTED



SALT SPRAY TESTED

Operating Temp: -40°C to 85°C,

Light Pattern: Symmetric,
Asymmetric, High, Low

Lens Material: Plastic

Housing: Cast Aluminium

Dampened

Mounting Options:
Hanging, Standing

Connector:
Deutsch (DT04-2P) built in

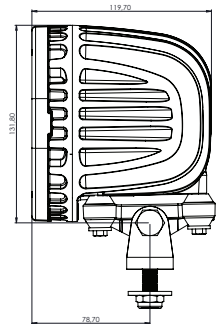
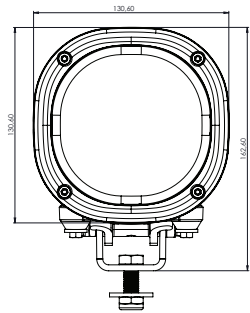

LUMEN OUTPUT		Number of LED'S	VOLTAGE		AMP DRAW		Power (Watts)	Colour Temp	CRI	COMPLIANCE / RATING						
Theoretical	Effective		Machine	Operating Range	12 Volts	24 Volts				EMC EN55025 / CISPR25	IP69K	Vibration 5-2000Hz 3 Axis	Salt Spray ASTM B117	UL Rated Optional	E Approved Optional	Shock Tested
4500 ⁽¹⁾	3600	4	12-48	9 60	4.0	2.0	48	5700	70	3	•	10 Grms*	•			
6300	5000	7	12-48	9 60	5.2	2.6	62	5700	70	4 (refractor) / 5 (reflector)	•	10 Grms	•			
8900	7000	7	12-48	9 60	6.8	3.4	82	5700	70	4 (refractor) / 5 (reflector)	•	10 Grms	•			

⁽¹⁾ Product may not be available in all territories; please check with your local TYRI office