



1010 BluePoint/RedPoint

PRODUCT INFORMATION:

1010 BluePoint and RedPoint LED increase safety and minimise the risk of accidents around machinery. The LED light projects a coloured, concentrated light beam as a large, visible square on the floor in front or behind the machine. This early warning signal alerts workers that there is a machine approaching. As an industry leading concept, it allows safety to be visual instead of relying solely on sirens and alarms, especially in noisy environments where hearing is difficult. The light is available in blue, and red.



EMC TESTED



IP69K



VIBRATION TESTED



SHOCK TESTED



SALT SPRAY TESTED



UL RATED OPTIONAL

Operating Temp: -40°C to 75°C

Light Pattern: Spot

Lens Material: Plastic

Housing: Cast Aluminium

Dampened

Mounting Options: Hanging, Standing, Side, Flush

Connector:
Deutsch (DT04-2P) built in

Weight: 915 g / 2.0 lb

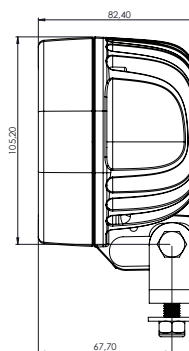
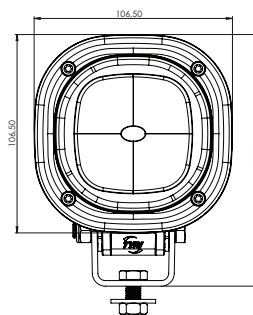

OPTICAL PROPERTIES					Number of LEDs	VOLTAGE			AMP DRAW			Power (Watts)	COMPLIANCE / RATING				
Model	Theoretical Lumen	Effective Lumen	Candela (cd)	Wavelength (nm)		Machine	Operating Range	12 Volts	24 Volts	EMC EN55025 / CISPR25	IP69K		Vibration 5-2000Hz 3 Axis	Shock Tested	Salt Spray ASTMB117	UL Rated Optional	
BLUE	N/A	N/A	20.000	475	4	12-48	9 60	1.2	0.6	15	Class 5	•	10 Grms	•	•		
RED	N/A	N/A	20.000	630	4	12-48	9 60	1.2	0.4	15	Class 5	•	10 Grms	•	•		

RISK GROUP 2 | CAUTION: Possibly hazardous optical radiation emitted from this product. Do not stare at operating lamp. May be harmful to the eye.

It is important to remember, LED work lights are no more hazardous than other lighting technologies with the same correlated colour temperature (CCT). TYRI is going above and beyond to ensure the safety of our customers by complying with the IEC/SS-EN 62471 standard and the addition of a warning label on the product.