



DBC 114067 SHD

Rear view camera

Heavy duty shutter camera



WEITERE INFOS

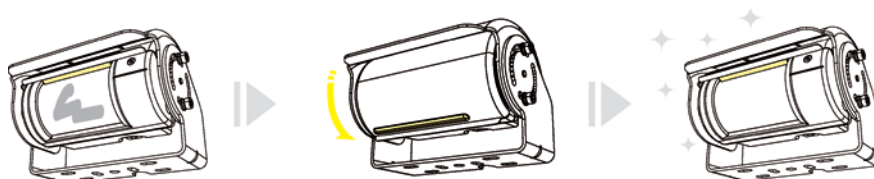

Features:

- Motorized color-camera with shutter and wiper
- Wide viewing angle 150°
- Waterproof IP69K
- 8 IR LED beamer for high performance in dark areas (0 lux)
- Built-in microphone
- Mirror/normal switch
- Automatic radiator
- Incl. 20 m connection cable

Technische Änderungen und Irrtümer vorbehalten.

DBC 114067 SHD

Rear view camera

Heavy duty shutter camera



Technical data:

- Sony 1/3 super HAD II CCD chipset
- Resolution: 320.000 pixels
- Built-in microphone
- Protection class: IP69K
- Mirror/normal switch
- With wiper-function during opening and closing of the shutter
- Signal / noise ratio: 30 dB
- Waterproof Al. housing
- Automatic, electronic iris
- Minimum illumination: 0 lux
- Vibration resistant up to 5 G
- Power supply: 12 V
- Power consumption: < 200 mA
- Operating temperature range: -30 °C to +80 °C
- Storage temperature range: -30 °C to +80 °C
- Dimensions (WxHxD) 104 x 57 x 55 mm
- Weight: approx. 480 g

EAN 40 41044 220401